

CUSTOMER INFORMATION BULLETIN

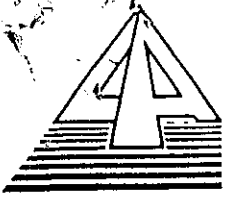

Department of
LAND ADMINISTRATION
OFFICE OF TITLES

REFERENCE ONLY. VALID AS AT PUBLICATION DATE SHOWN ON THIS DOCUMENT.

No. 3, March 30, 1988

TITLES OFFICE AMG INDEX PLAN SEARCHES
GRAPHIC BANK FREEHOLD COUNTER - 1ST FLOOR, LAW CHAMBERS

The Office of Titles is soon to commence an extensive programme of microfilming survey plans, diagrams and field notes using Cameronic's microfilm cameras. Because of the large number of documents involved it is anticipated the project will extend over several years. The exercise will commence with the microfilming of the 2000 or so AMG index plans located in the Graphic Bank Freehold area on the 1st Floor of Law Chambers. It is expected that these will be available in a microfiche form for public search by the end of May 1988.

It is intended to make the microfiche available with viewing facilities for public search. It is not intended to make any charge for this facility unless copies of plans are requested by searchers. Because this free searching facility for index plans is to be soon introduced, and as a consequence of discussion with the Association of Consulting Surveyors, the fee currently charged for searching index plans will no longer apply as from today's date. A search fee of \$3.00 will still be charged if a copy or a dye line print of the index plan is requested.

D.L. Mulcahy
Director
LAND TITLES

In response to staff initiatives designed to improve turn-around time in the preparation of new Certificates of Title, the following procedural changes are to take place effective immediately.

1. Colouring of Private Roads, R's.O.W. and P.A.W's. is to Cease :

Traditionally colour has been used to denote an expressed or implied right, however, private roads, R's.O.W and P.A.W's. etc. are not shown as abuttals unless such a right exists. It has been agreed therefore that the use of colour on title diagrams is not necessary and should cease forthwith.

2. Colouring of Simple Easement Encumbrance Diagrams on Certificates of Title is to Cease :

In future broken lines will be used to identify easement boundaries as distinct from cadastral boundaries which will be shown as full lines. To further identify the land the subject of the easement, the diagram is to be labelled with an alpha identifier. (See figure 1 for example diagram and the new text for endorsement of the easement).

FIGURE 1

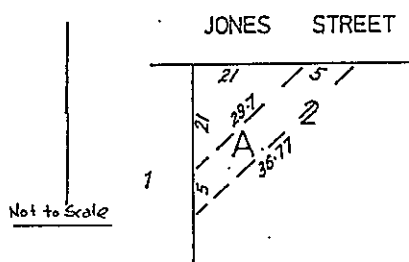

Transfer D000000. The right to enter upon the portion of the within land marked "A" on the map in the margin for the purpose of exercising certain water rights as set out in the said Transfer is granted to the City of Stirling. Dated

3. Colouring of Title Diagrams which enjoy the Benefit of an Easement is to Cease :

The same conditions as specified in Section 2 of this notice apply with the exception of the benefit recital text which describes the Dominant Easement Tenancy as set out in figure 2 below

FIGURE 2

..... together with a right of carriageway over the portion of lot 3 on Diagram 99999 marked "A" on the said map hereon as set out in Transfer D000000

SECOND SCHEDULE

NIL

THIRD SCHEDULE

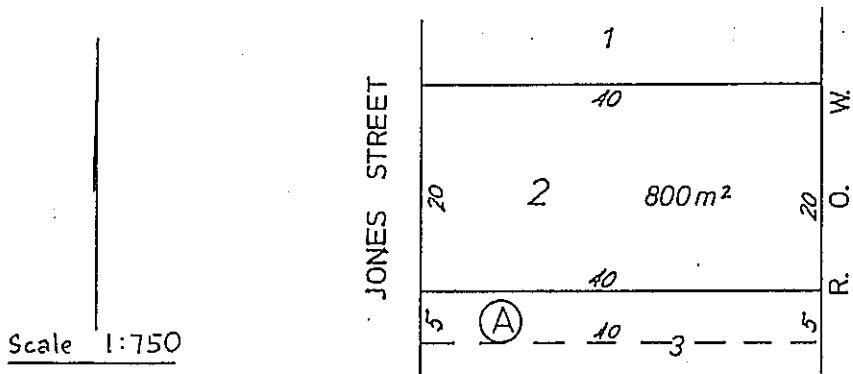

4. Notwithstanding the above, special circumstances will occasionally require the continued use of colour.

D L Mulcahy

D L MULCAHY
DIRECTOR
LAND TITLES

19 February 1988